

Plans Mecaniques

Sommaire et recommandations	1 - 2
<u>Plans mecaniques</u>	
Plan d'ensemble échelle 1/3	3 - 4
Echelle 1	
Plateau inférieur supports réservoir et servo	5 - 6 - 7 - 8
Flans et dessus	9 - 10 - 11 - 12 - 13
Support des cartes de façades	14
Façades	15
Pièces boîtier accus	16
Boîtier Accus	17
Support réservoir	18
Chassis support échelle 1/3	19
Faces avant papier	20

Recommandations: **Attention, les arrêtes cachées sur les plans ne sont pas toujours en pointillé, c'est trop de temps.**

Il y a des pointillés fins mauves qui permettent de couper les plans pour les assembler.

Matériel nécessaire:

- CTP de 15mm, CTP de 10mm, CTP 5mm, CTP 3mm
- Un coude PVC de 100mm pour dévier les gaz d'échappement vers le bas
- Tôle d'aluminium perforée pour le couvercle du dessus.
- 1 servo standard et un réservoir 450cc ecotop Topmodel ref 066T450
- 1 bati moteur de rodage adaptable TopModel ref 0436300



- Tube carré acier 25mm
- Plastique transparent 2mm pour façades.

Montage:

Toutes les pièces sont découpées en collant le plan sur le CTP. Veiller à ce que l'imprimante donne bien l'échelle.

Assemblage de l'ensemble à la colle à bois.

Mise en place de 4 inserts pour les 2 vis de réglage de la position du servo en fonction des moteurs

Le coude en PVC est tenu par des petites équerres.

L'afficheur et la carte Bouton poussoir sont assemblés sur les supports à l'aide de petite vis, l'ensemble est collé en place en prenant soin de l'alignement de façade.

Apprêt et peinture.

Les accus sont callés par du plastique d'emballage genre sous couche parquet.

Le bati moteur peut prendre 2 positions suivant la grosseur des moteurs.

Bonne réalisation.

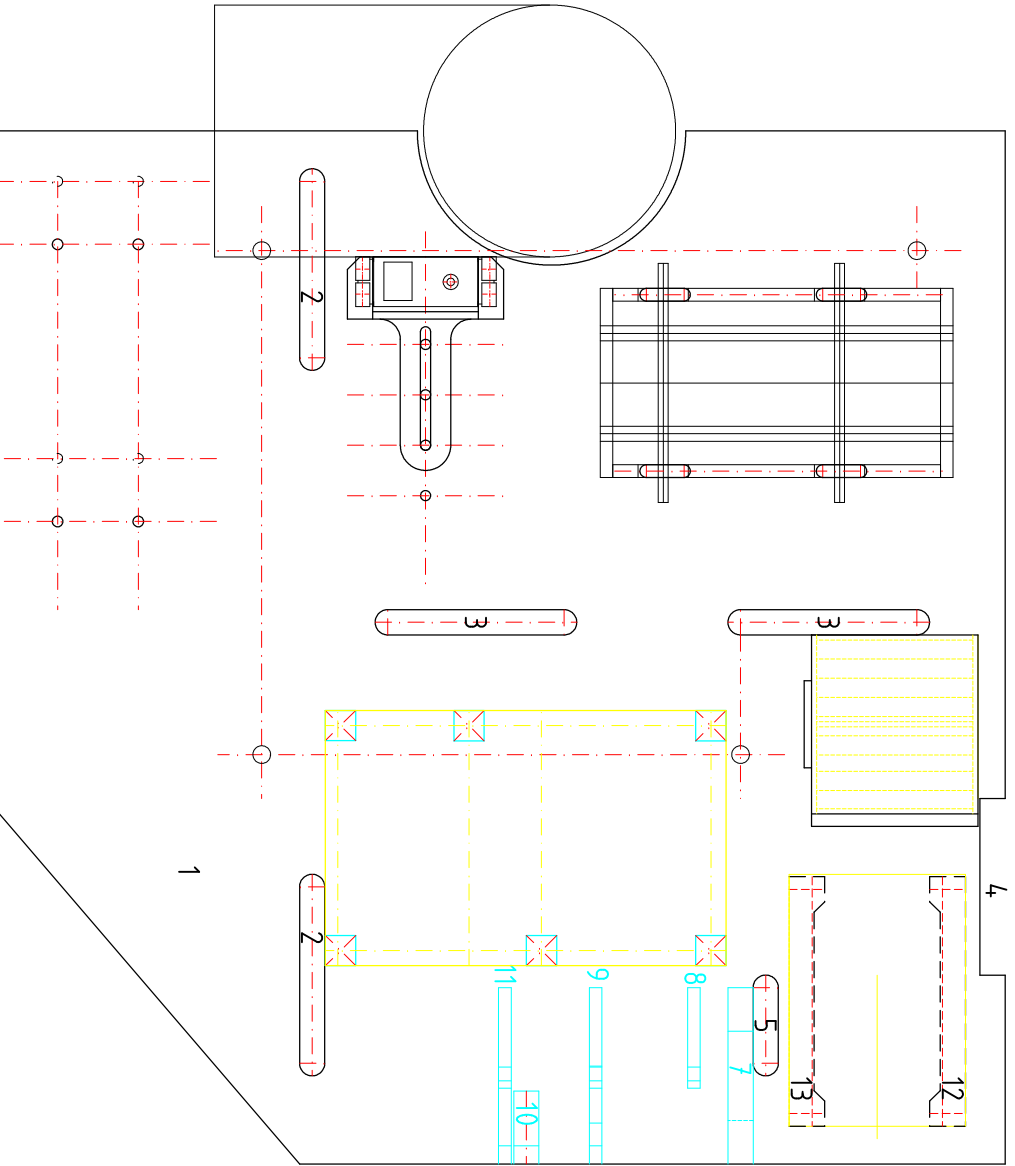
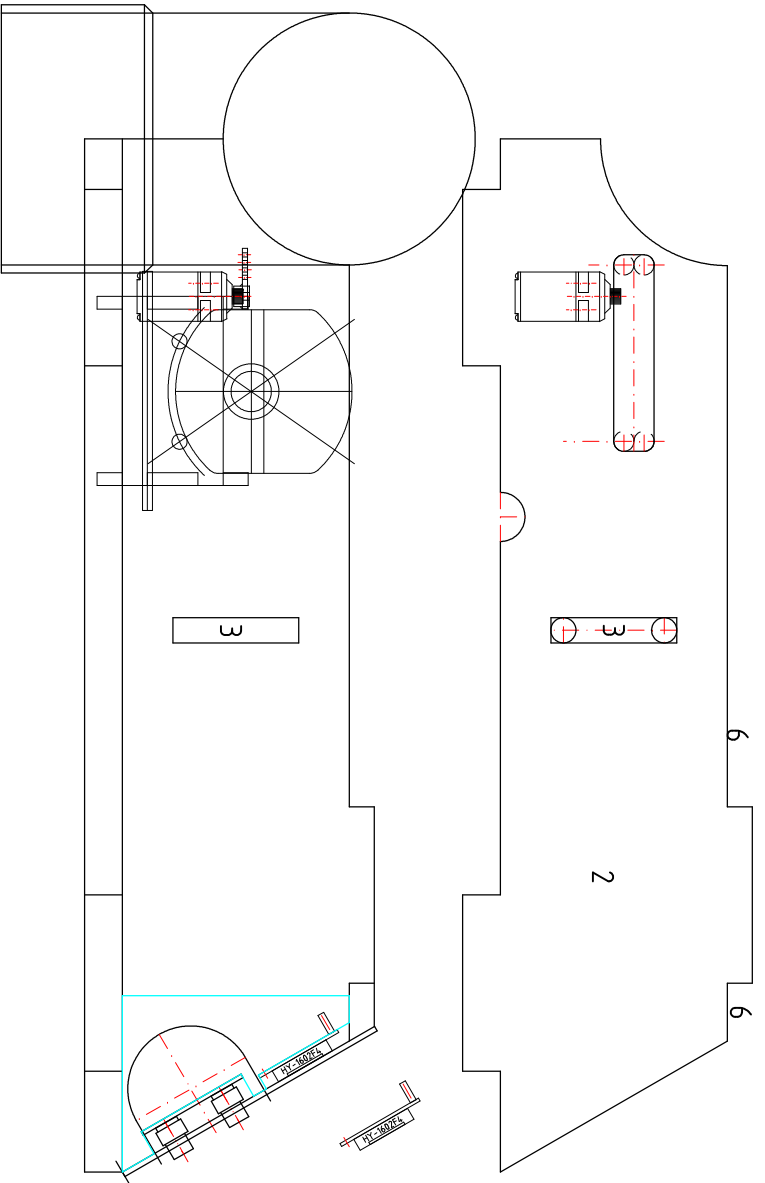

AERODEN
Echelle 1/3

Folio 3

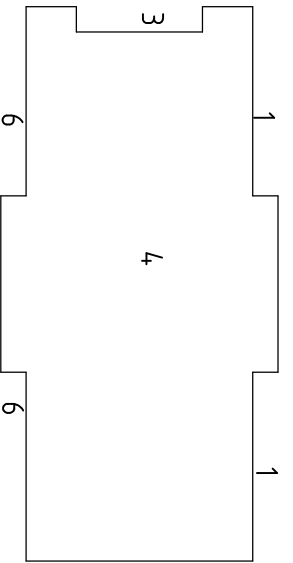

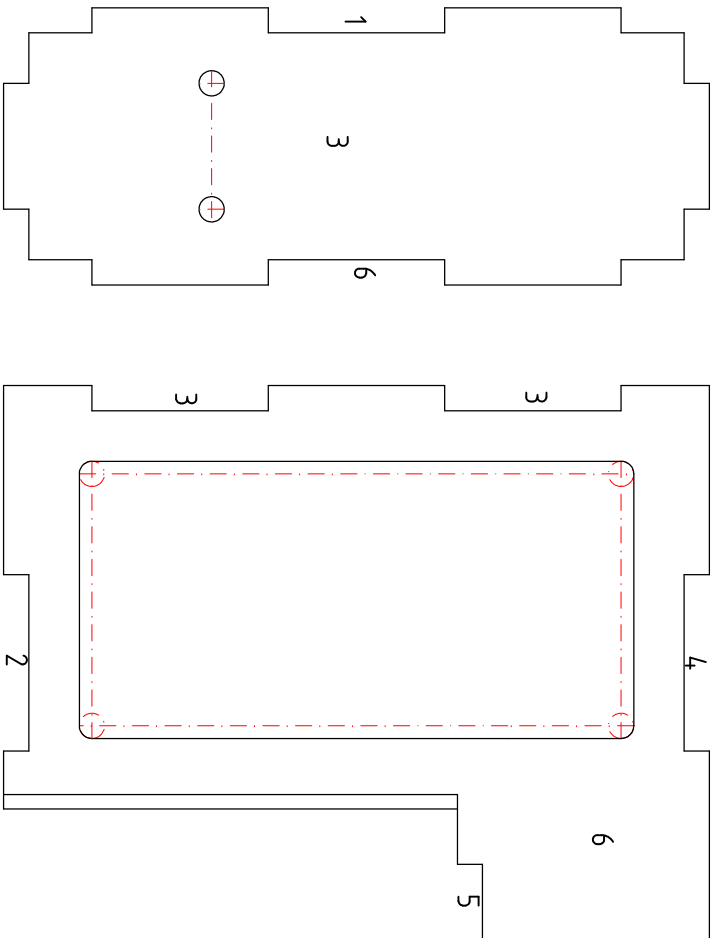
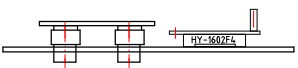
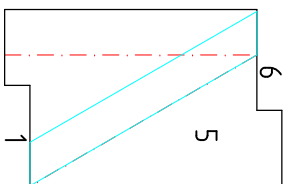
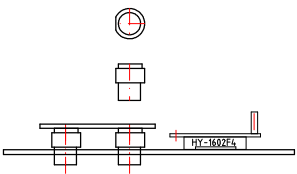
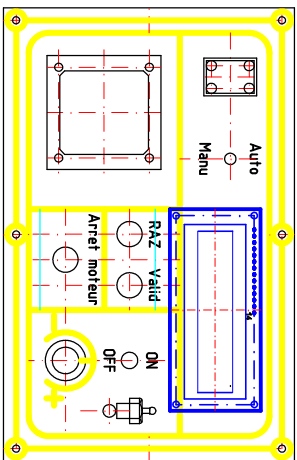
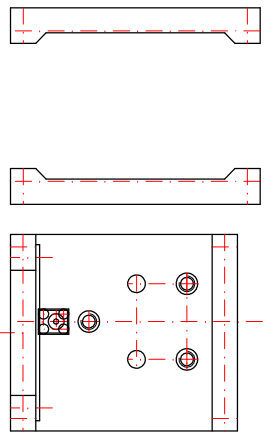

AERODEN Folio 4
 Echelle 1/3

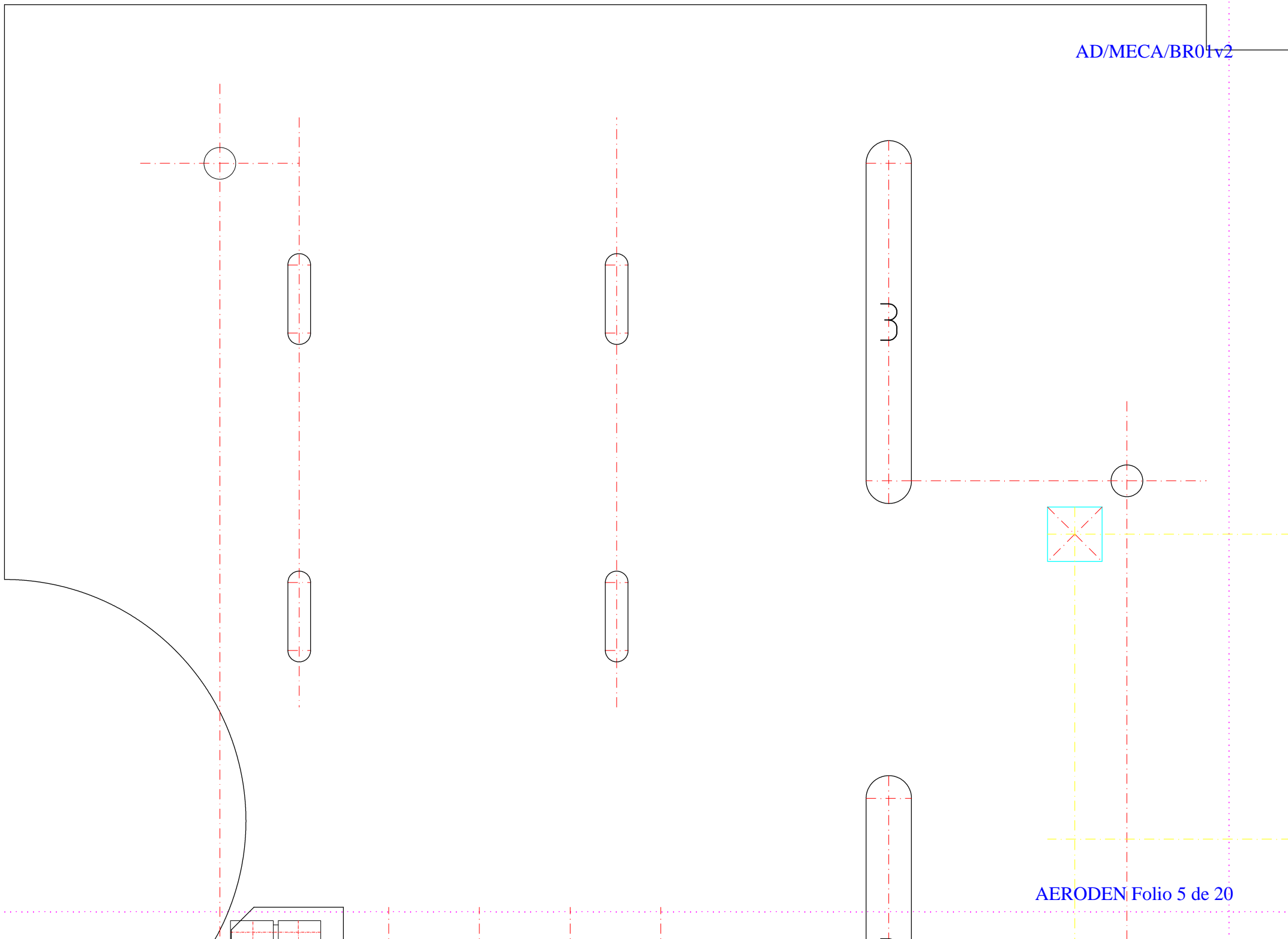

4

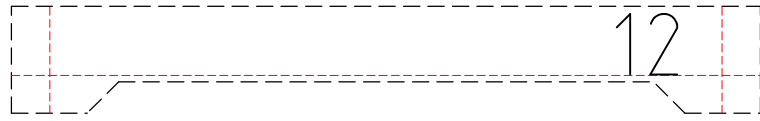

Support carte

Support carte

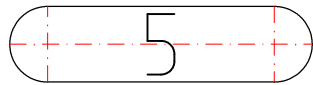
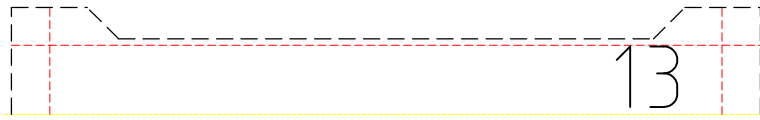

AD/MECA/BR01v2

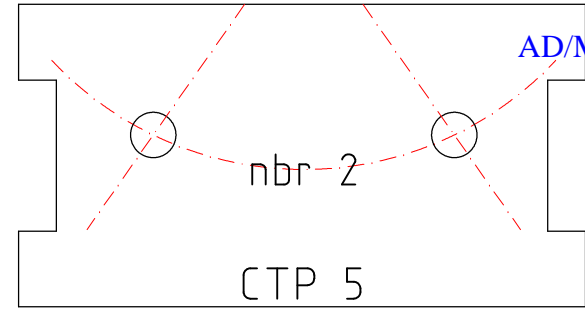

CTP 5

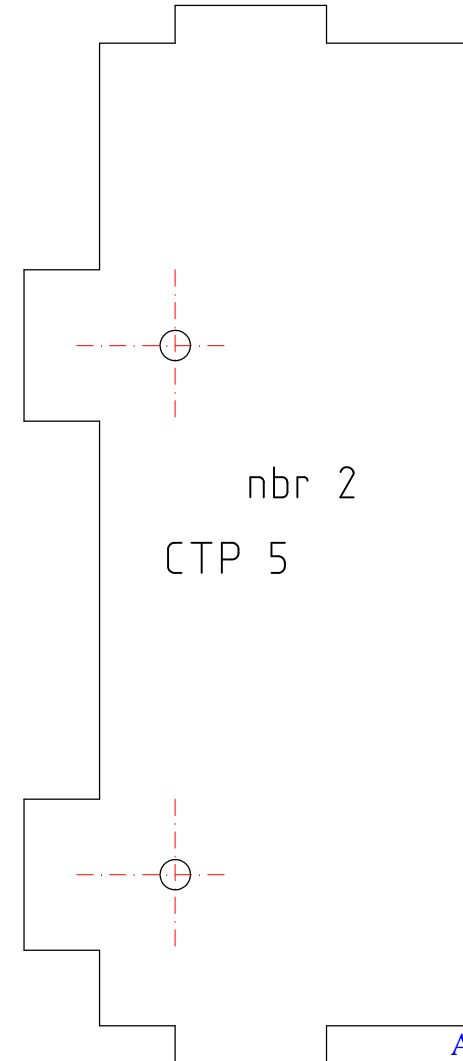

nbr 2
CTP 5

Piece support reservoir

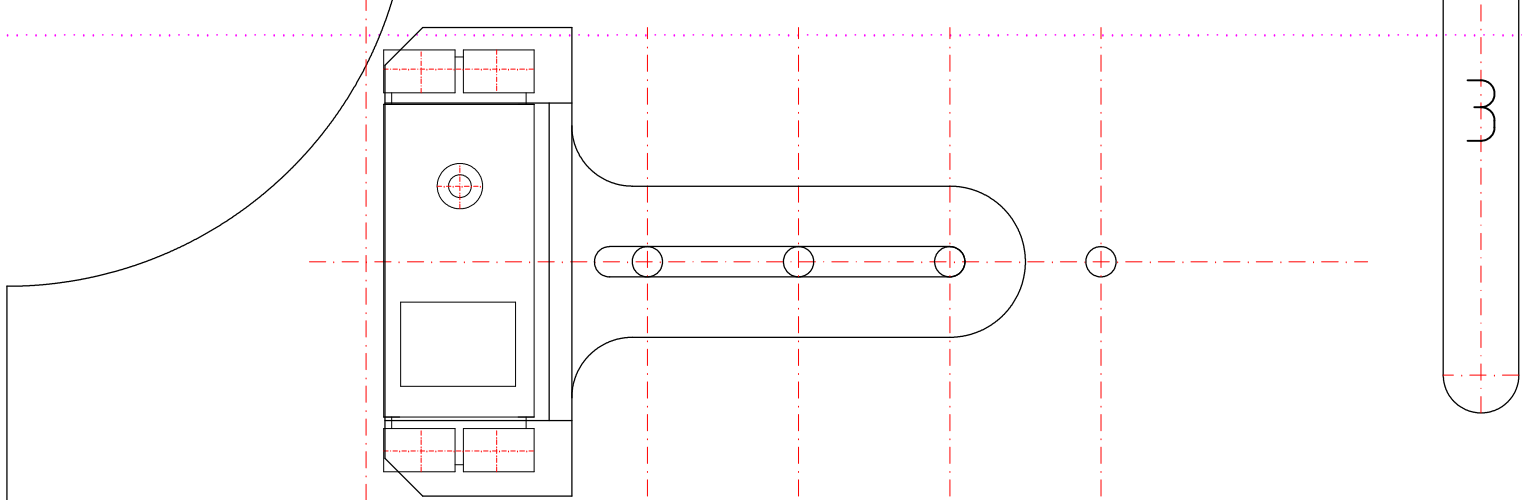

AD/MECA/BR01v2

Decalage v pour la

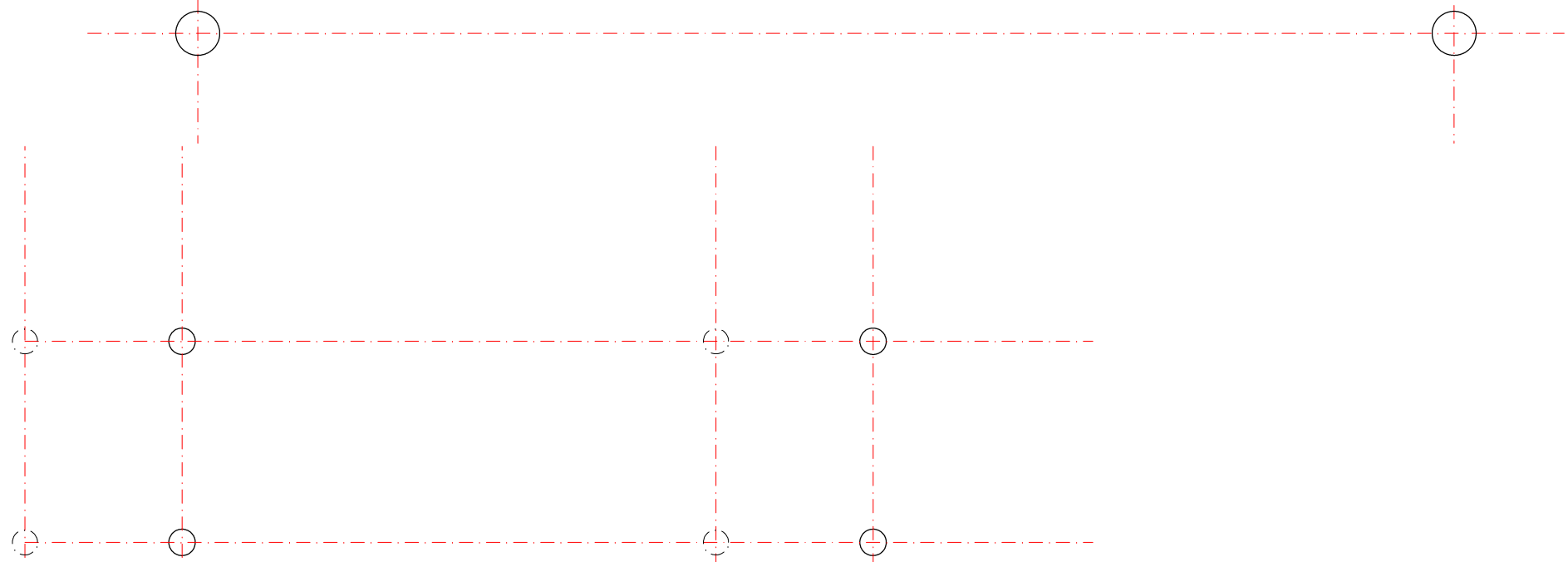
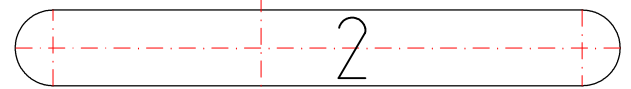
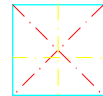

calage volontaire pour la paroi

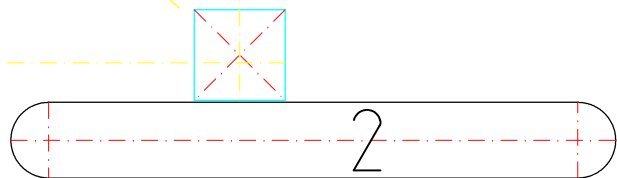

1
CTP 15

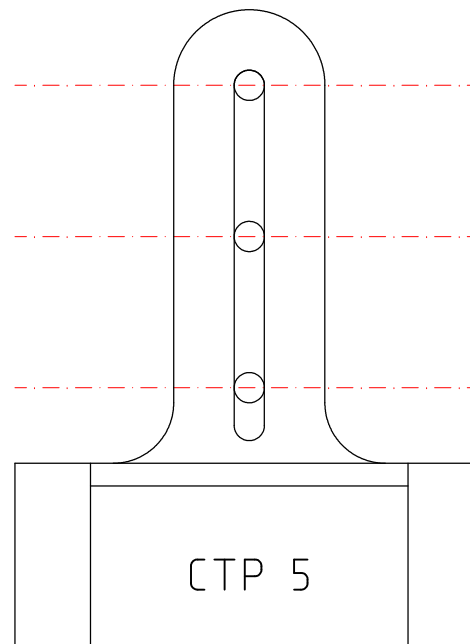

Piece support servo

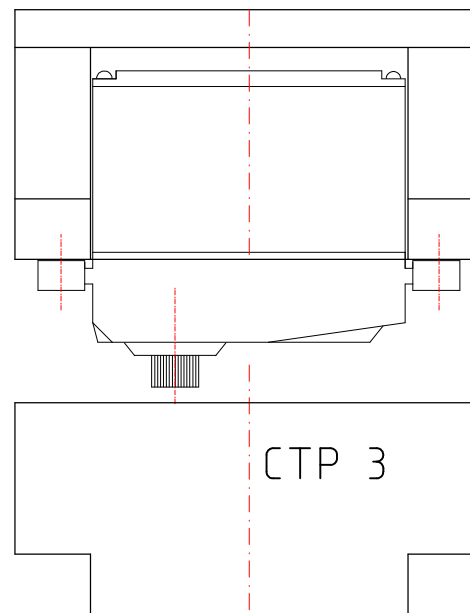

nbr 2
CTP 10

3

CTP 10



6

CTP 10



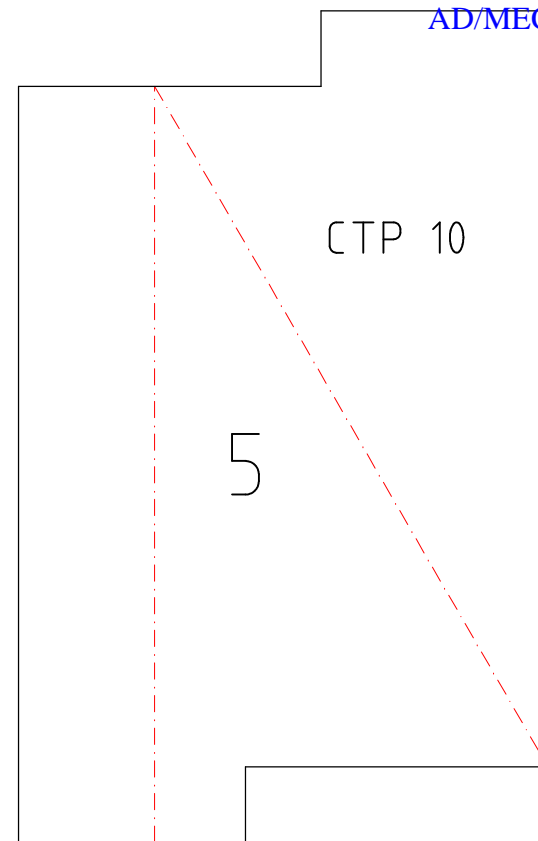
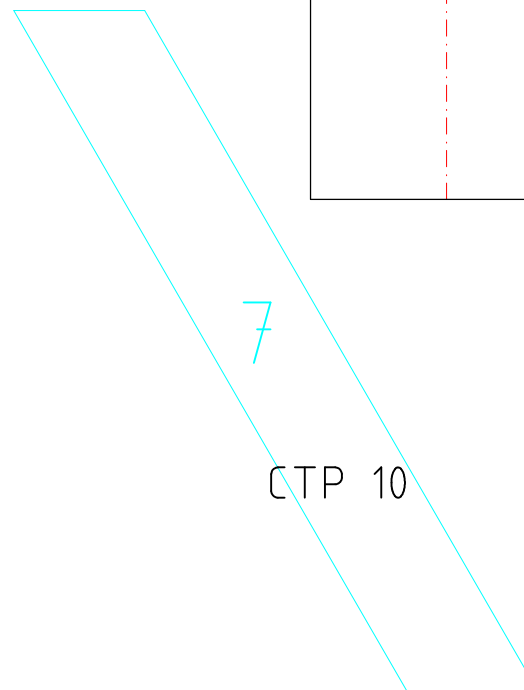
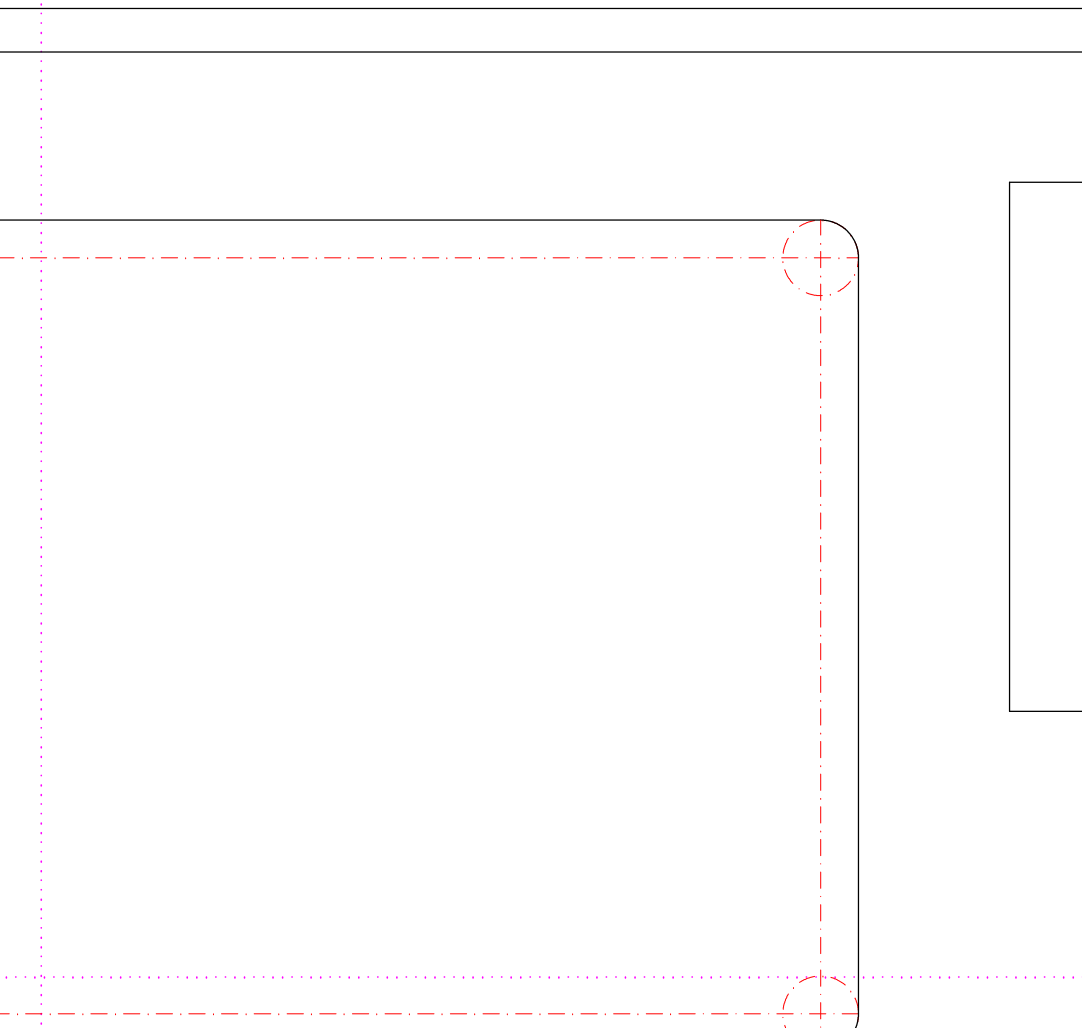

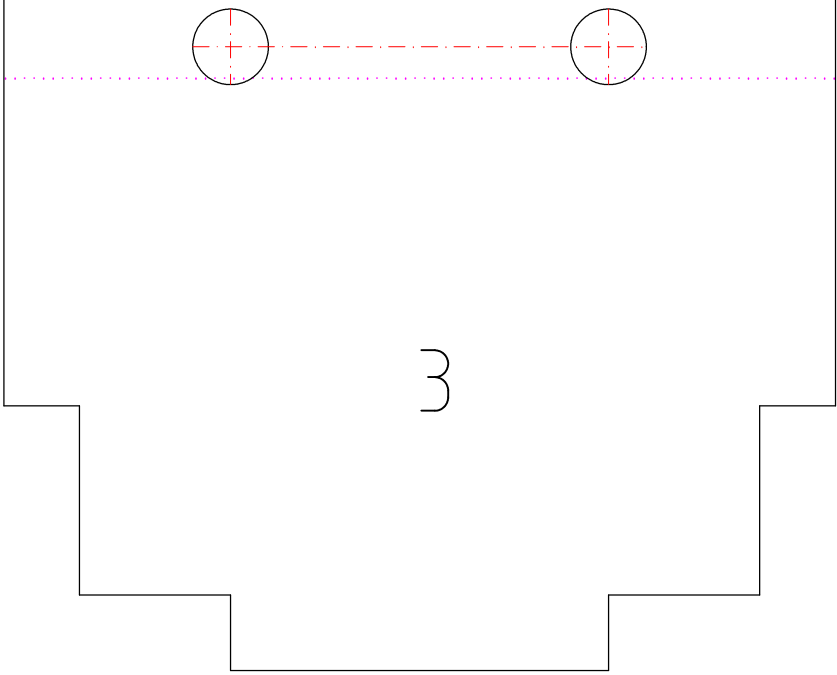

3

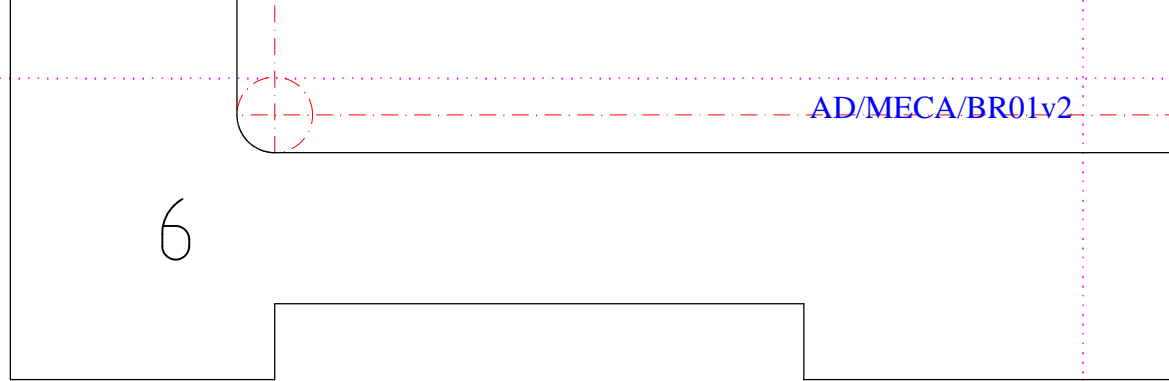

6

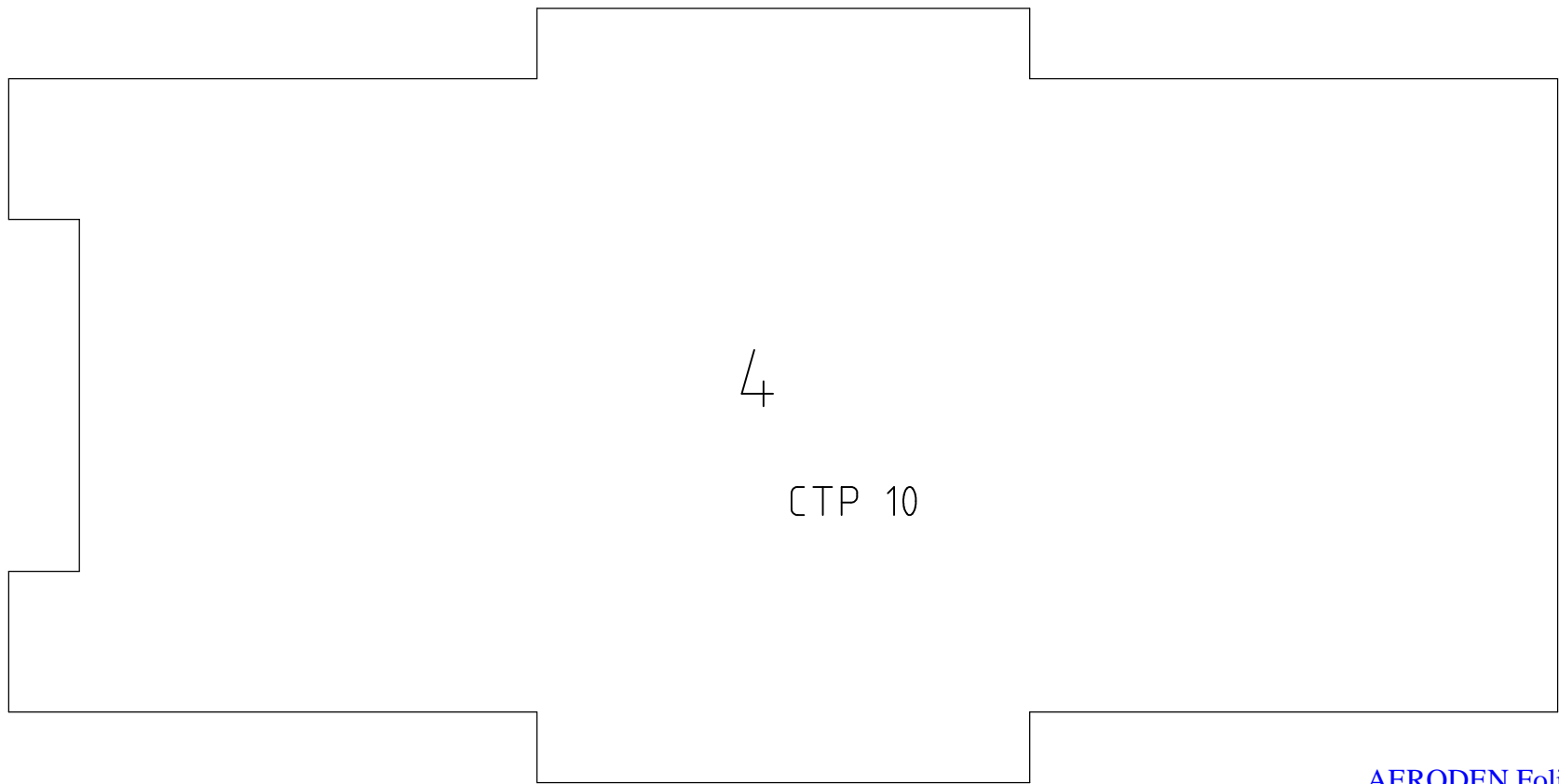

4

CTP 10

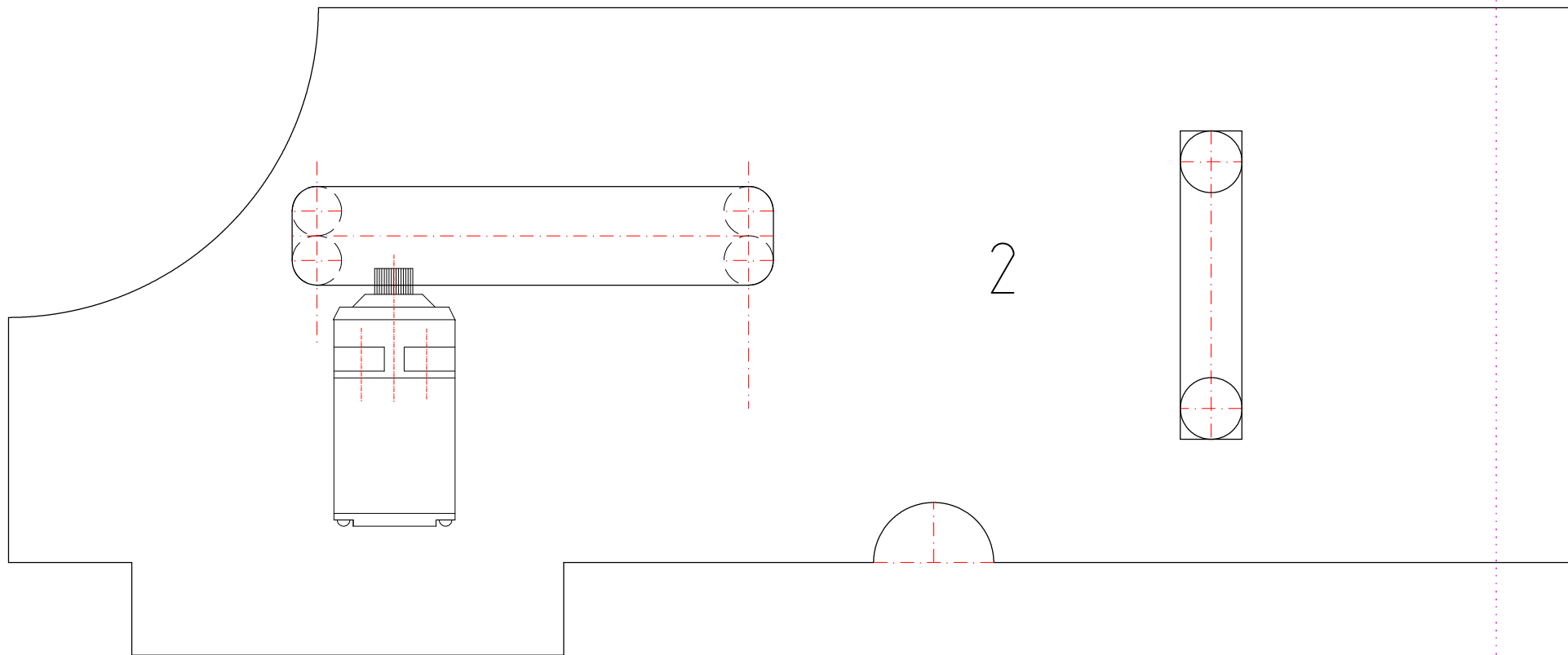
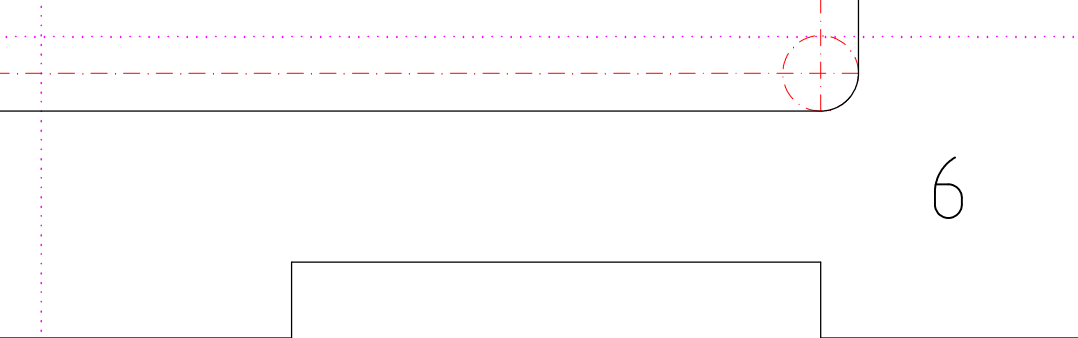

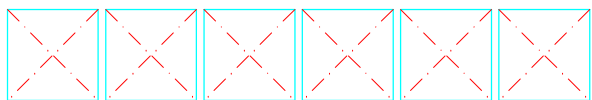

Supports carte prinipale
CTP 10mm

Support afficheur
support Cir Imp Bouton poussoir
CTP 5mm

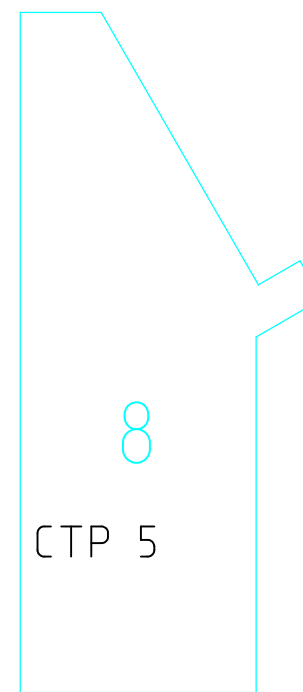
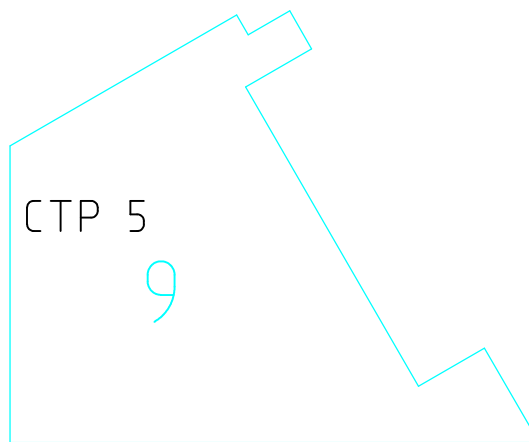
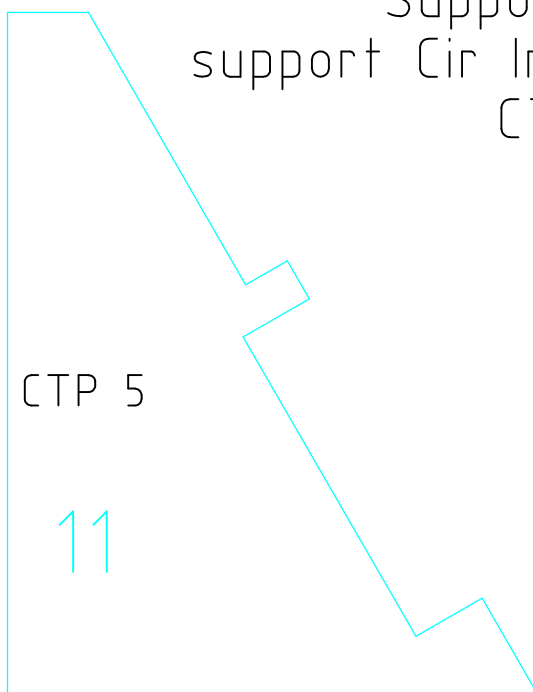
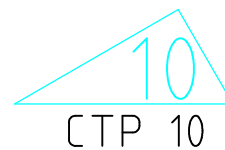

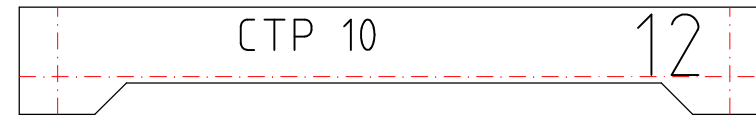
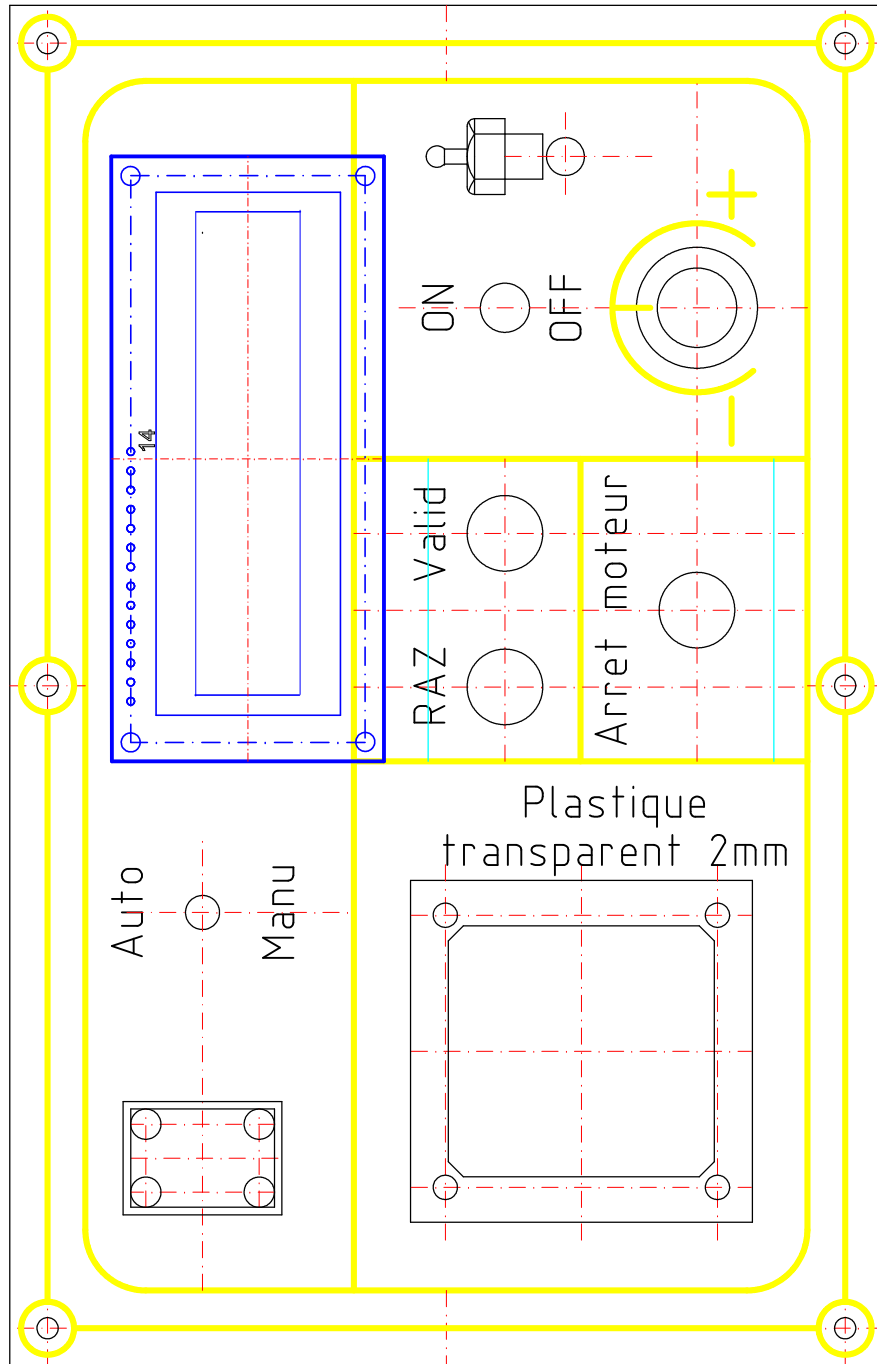

Support carte

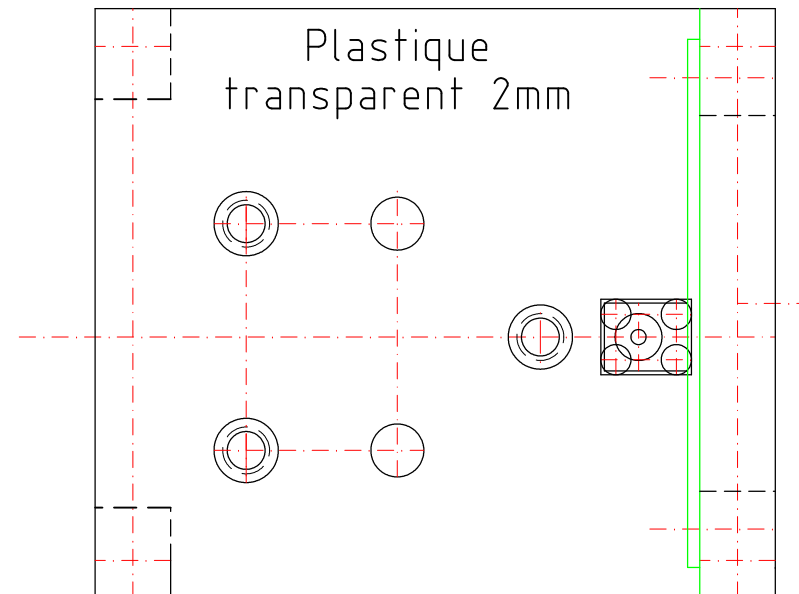

CTP 5
14

CTP 10
15

CTP 5
16

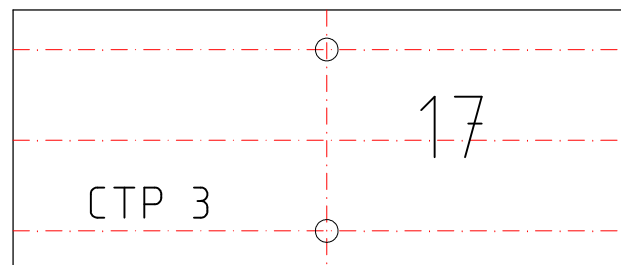

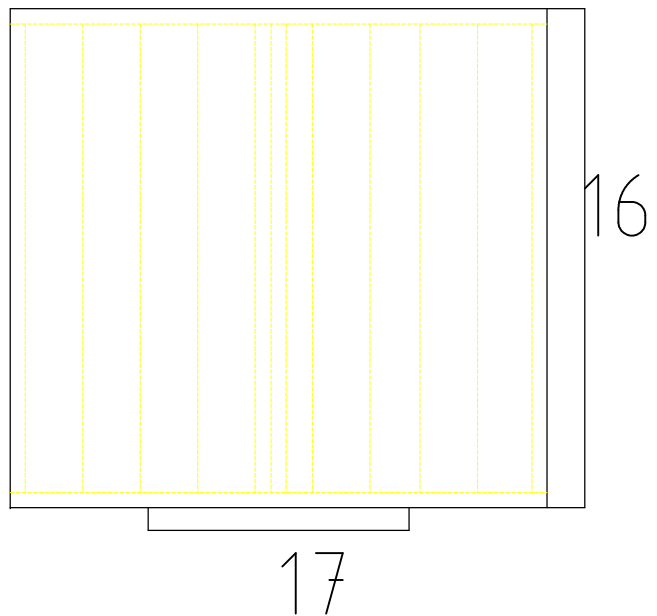
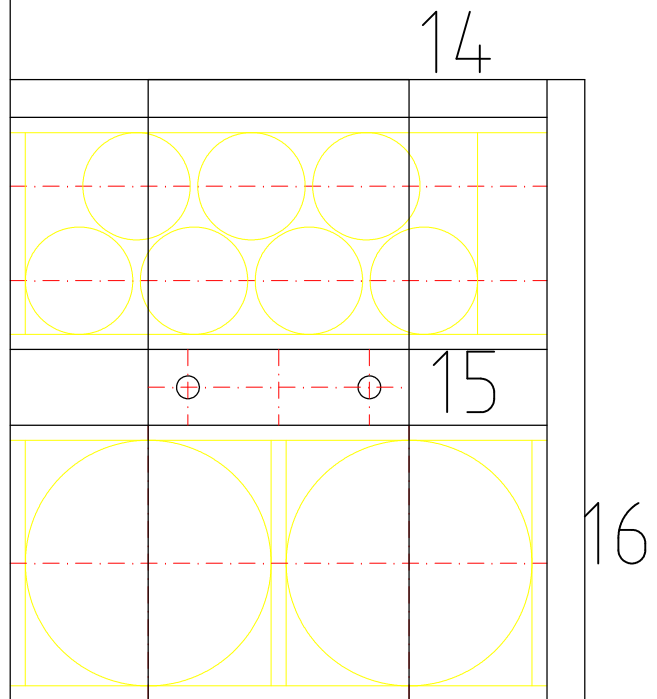

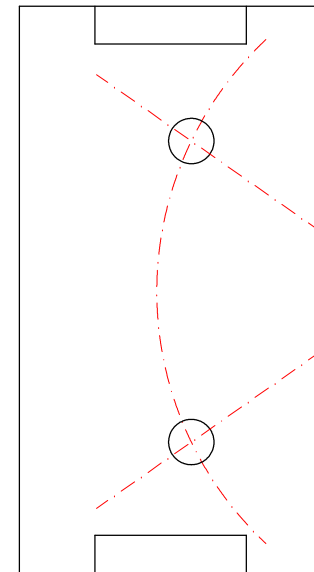
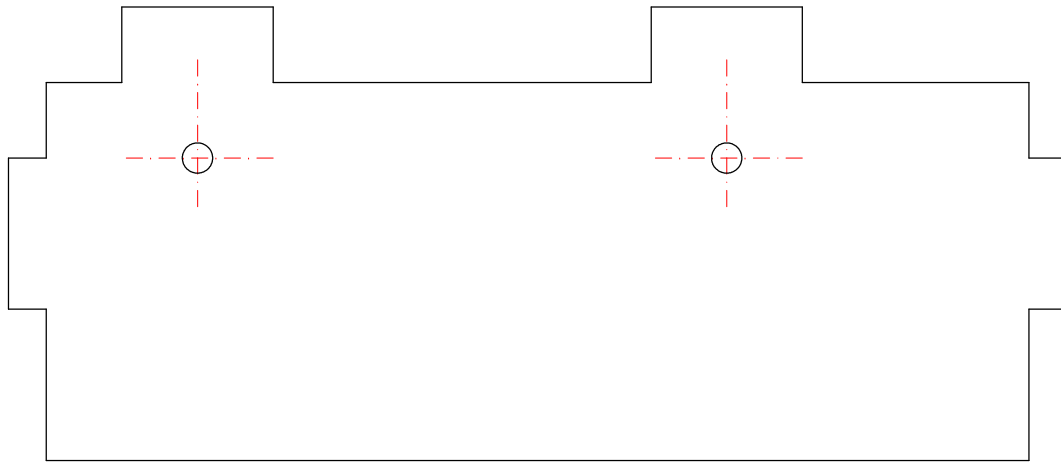
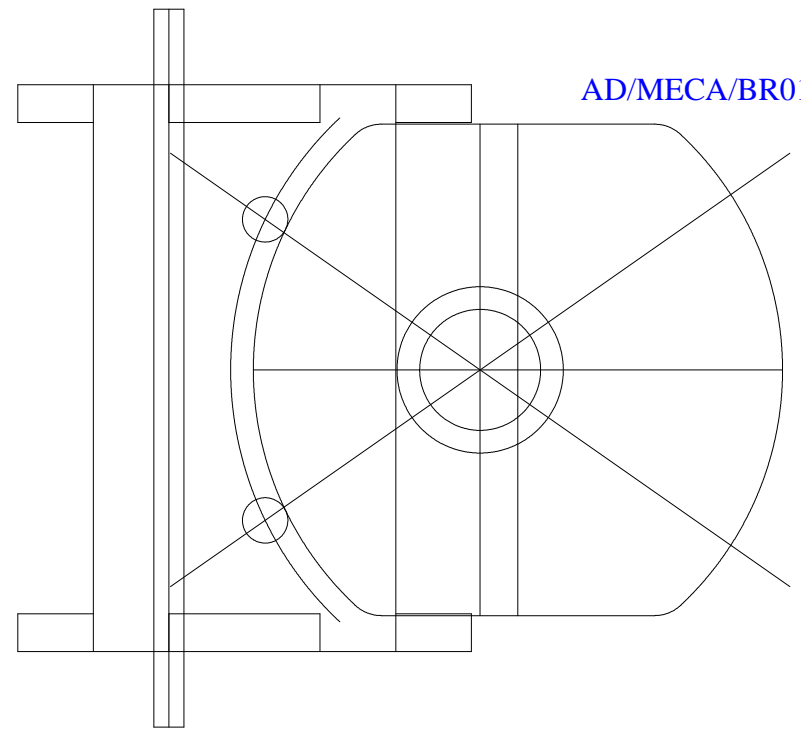
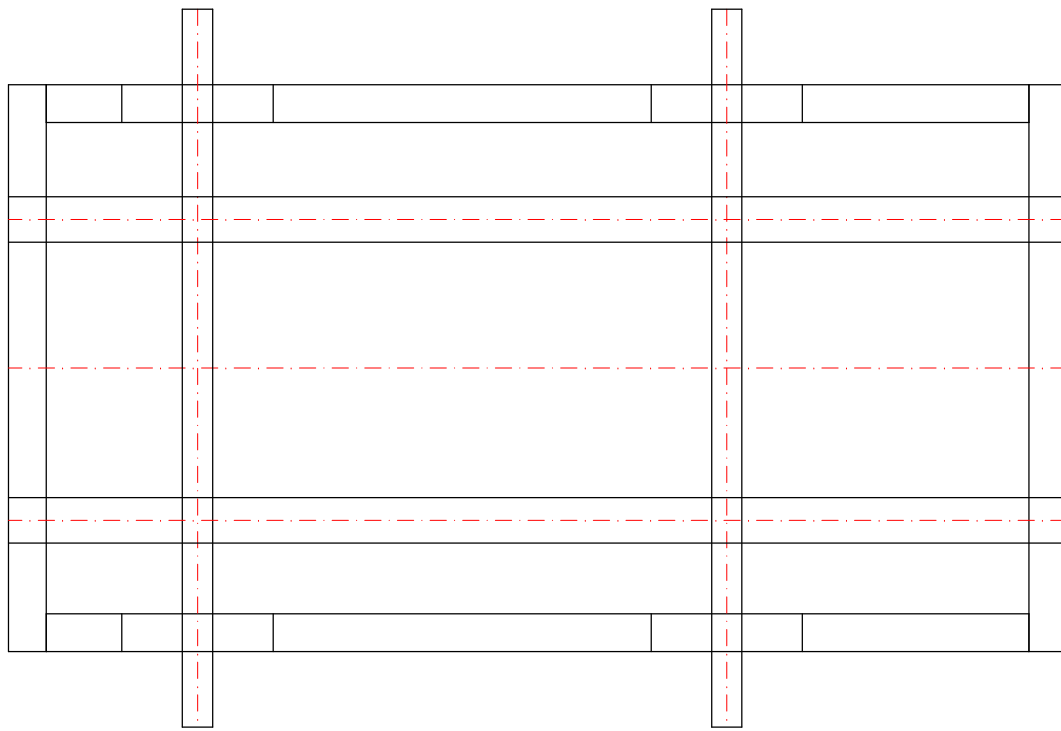

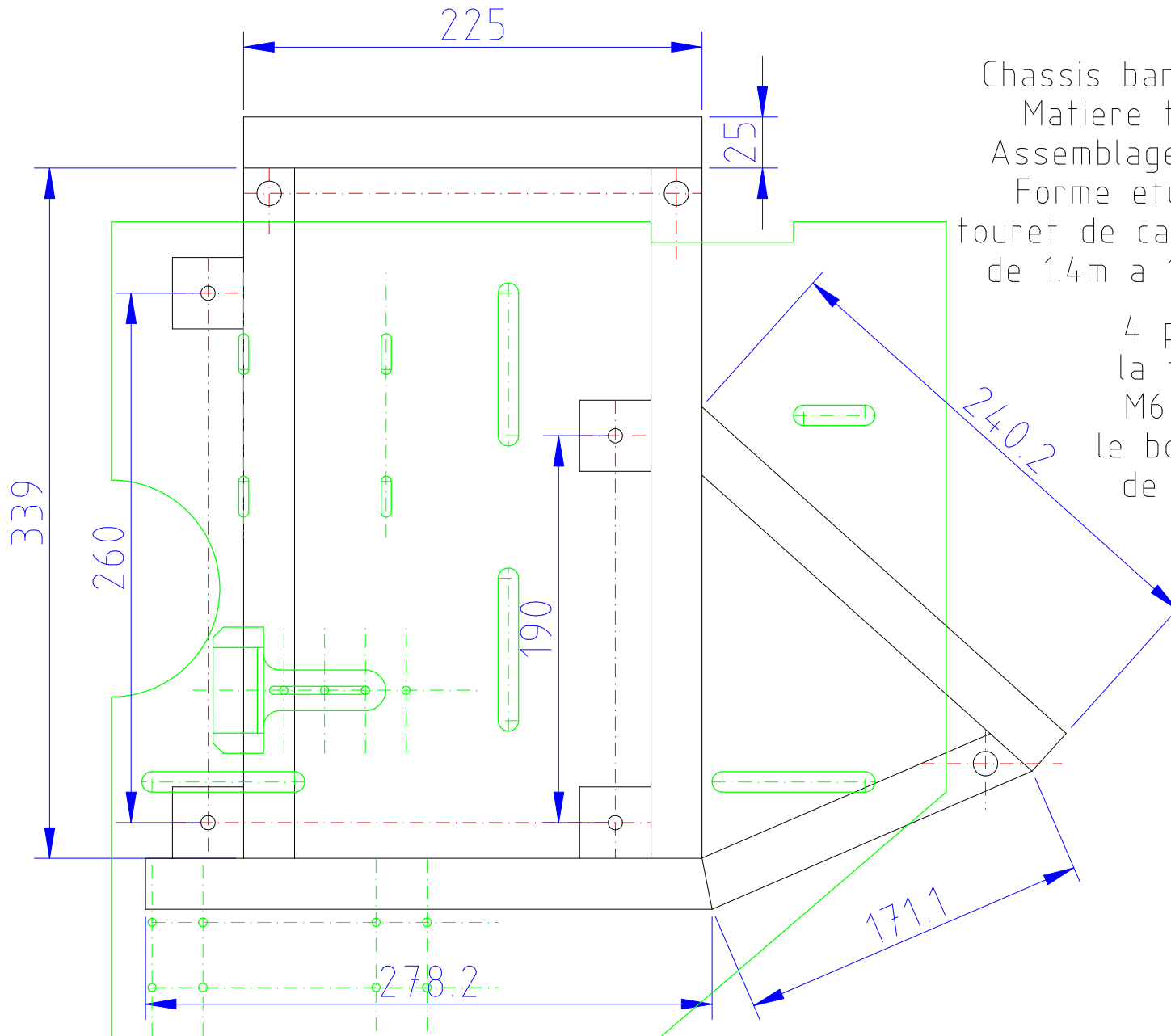

Chassis banc de rodage: echelle 1/3
 Matiere tube acier carre de 25
 Assemblage par soudure electrique
 Forme etudiee pour fixation sur
 touret de cable electrique de diametre
 de 1.4m a 1.6m par tige filetée M10

4 pattes de 35x35 permettent
 la fixation du boitier par 4 vis
 M6 avec ecrous nylstop. Entre
 le bois et la patte une epaisseur
 de caoutchouc dur de 5mm est
 intercalee.

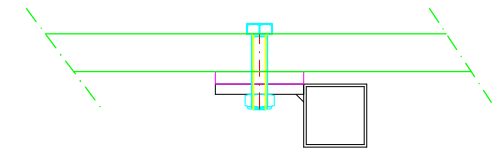

AERODEN-BR01

Auto
Manu

RAZ Valid

Arret moteur

ON glow

OFF

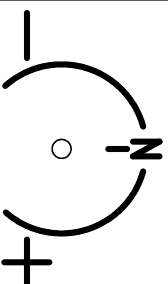
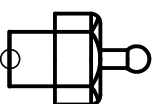

Courant glow

Accu 8,4v

Charge ON

Accu 2,4v glow

Charge ON

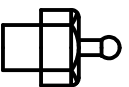

Charge en 12 h

